

हर टाइल के  
पीछे MAGIC

## STANDARD+ ADHESIVE

TECHNICAL DATA SHEET



High Bond  
Strength



Water  
Resistant



Anti-  
Bacterial



No Sag



Easy to Mix  
& Apply



Low  
VOC



Available in 20 kg Bag

## PRODUCT DESCRIPTION

Standard+ Adhesive is a polymer integrated cement composition-based adhesive for fixing ceramic tiles & vitrified tiles (normal size) on floors and walls. It comes in a premixed, ready to use form that can be used with a number of substrates. It is water resistant and doesn't allow cracking of tiles.

## SUITABLE FOR

### Material & Area

- Tile on tile
- Medium format vitrified tiles on internal floor and wall
- Ceramic tiles and tiles with a porosity of >3% on internal floor and walls
- Residential and commercial application
- Dry & wet areas

### Substrate

- Cement mortar beds
- Cement based plaster
- Concrete surfaces
- Cement based screed
- Cement terrazzo
- Brick masonry
- AAC block masonry
- Concrete block masonry

## TECHNICAL DETAILS

Conforms to IS 15477:2019 Type 2'T' ; EN 12004 C1TE

## PHYSICAL PROPERTIES @ 70° F (21° C)

Tile laying adhesive mixed with water

PARAMETERS	RESULTS
Colour	Grey/White
Mixing Ratio (Powder To Water)	3.5 : 1
Bulk Density	1.3 - 1.5 gm/cc
Mixing Density	1.7 - 1.9 gm/cc
Pot Life	> 2 Hours
Open Time	~30 Minutes
Adjustability	~30 Minutes
Final Setting Time	24 Hours
Max. Bed Thickness	12 mm
Time To Light Foot Traffic	16 - 24 Hours
Ready For Grouting	24 Hours
Ready For Use	14 Days

## PERFORMANCE PROPERTIES

Tile laying adhesive mixed with water

### IS 15477:2019

PARAMETERS	REQUIREMENTS	RESULTS	TEST METHODS
Tensile Adhesion (Dry Condition 28 Days)	$\geq 1 \text{ N/mm}^2$	$1-1.1 \text{ N/mm}^2$	IS 15477:2019 Annexure A Clause 5.1
Shear Adhesion (Dry Condition 28 Days)	$\geq 1.25 \text{ N/mm}^2$	$\geq 1.25-1.27 \text{ N/mm}^2$	IS 15477:2019 Annexure B Clause 5.2
Slip Resistance	$< 0.5 \text{ mm}$	$0.3-0.4 \text{ mm}$	IS 15477:2019 Annexure E Clause 5.5

Standard + adhesive mortar conforms to IS 15477:2019 Type 2'T'

### EN 12004

PARAMETERS	REQUIREMENTS	RESULTS	TEST METHODS
Open Time: Tensile Adhesion Strength	$\geq 0.5 \text{ N/mm}^2$ after not less than 20 min	$0.5-0.6 \text{ N/mm}^2$	EN 1346
T – Slip Resistance	$\leq 0.5 \text{ mm}$	$0.35-0.44 \text{ mm}$	EN 1308
Tensile Adhesion Strength (C1)	$\geq 0.5 \text{ N/mm}^2$	$0.55 - 0.6 \text{ N/mm}^2$	EN 1348 Clause 8.2
Tensile Adhesion Strength (After Water Immersion)	$\geq 0.5 \text{ N/mm}^2$	$0.55 - 0.6 \text{ N/mm}^2$	EN 1348 Clause 8.3
Tensile Adhesion Strength (Heat Ageing)	$\geq 0.5 \text{ N/mm}^2$	$0.55 - 0.6 \text{ N/mm}^2$	EN 1348 Clause 8.4
Tensile Adhesion Strength (Freeze & Thaw)	$\geq 0.5 \text{ N/mm}^2$	$0.55 - 0.6 \text{ N/mm}^2$	EN 1348 Clause 8.5

Standard + adhesive mortar conforms to EN 12004 C1TE/ISO 13007

### ANSI A118

PARAMETERS	REQUIREMENTS	RESULTS	TEST METHODS
Extended Open Time (30 Minutes at 28 Days)	$\geq 0.5 \text{ N/mm}^2$	$0.55-0.6 \text{ N/mm}^2$	ANSI A118.1 Clause 5.3
Sag Resistance	$\leq 0.5 \text{ mm}$	$0.3-0.4 \text{ mm}$	ANSI A118.1- Clause 6.0
<b>Glazed Wall Tile</b>			
Shear Strength (7 Days Normal Condition)	$> 1.38 \text{ N/mm}^2$	$1.4-1.45 \text{ N/mm}^2$	ANSI A118.1 Clause 7.1.2
Shear Strength (7 Days Water Immersion)	$> 1.03 \text{ N/mm}^2$	$1.1-1.2 \text{ N/mm}^2$	ANSI A118.1- Clause 7.1.3
<b>Porcelain Mosaic Tile</b>			
Shear Strength (1 Day Normal Condition)	$0.34 \text{ N/mm}^2$	$0.4-0.45 \text{ N/mm}^2$	ANSI A118.1 Clause 7.2.2
Shear Strength (7 Days Normal Condition)	$1.03 \text{ N/mm}^2$	$1.1-1.2 \text{ N/mm}^2$	ANSI A118.1- Clause 7.2.3
Shear Strength (7 Days Water Immersion)	$0.69 \text{ N/mm}^2$	$0.75-0.85 \text{ N/mm}^2$	ANSI A118.1 Clause 7.2.4
Shear Strength (28 Days Normal Condition)	$1.03 \text{ N/mm}^2$	$1.1-1.2 \text{ N/mm}^2$	ANSI A118.1- Clause 7.2.5
Shear Strength (12 Weeks Normal Condition)	$1.03 \text{ N/mm}^2$	$1.1-1.2 \text{ N/mm}^2$	ANSI A118.1 Clause 7.2.6

Standard + adhesive mortar conforms to ANSI A118.1T

## INSTALLATION

### Surface Preparation



- All surfaces must conform to the dimensional stability requirements outlined in IS 1443-2018.
- They should be level, properly cured, undamaged, compact, rigid, resistant, dry, free from any debonding agents, and protected against damp rising.
- Pre-wet or dampen highly absorbent concrete surface with good quality fresh water.

### Mixing

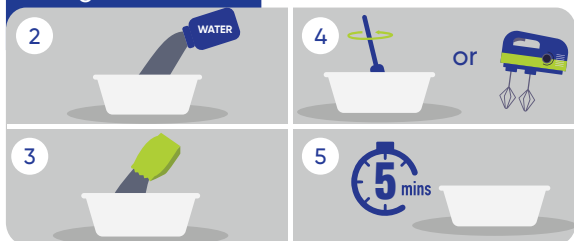

- Use 5-6 litres of potable water for every 20 kg of adhesive.
- Pour the minimum recommended amount of potable water into a clean mixing container.
- Gradually add dry mix product to the water (not vice versa) while continuously mixing it with a low-speed electric single-paddle (spiral) mixer for mixing at a speed of <500 rpm.
- Mix thoroughly for 2-3 minutes or until you achieve a uniformly colored, smooth mixture. Add additional water, if necessary, but do not exceed the maximum specified amount.
- Allow the mixed product to 'mature' for 4-5 minutes without stirring.
- Remix for 15 seconds just before using.
- Avoid over-mixing to minimize air entrainment

### Application



- The adhesive needs to be applied with a flat side of the trowel using a scrapping motion.
- Additional mortar should be then applied with the notched edge of the trowel.
- For large size tiles with sides > 2 feet, apply additional adhesive to the back of the tile surface with the flat side of the trowel.
- Occasionally check to inspect tiles are properly stuck. If the adhesive seems to be non-sticky, remove the existing and replace with fresh adhesive. Use a rubber mallet to tap the tile and ensure it is fully bedded in the adhesive.

### To create elastic expansion joints, follow these guidelines:

- For external applications, create 5 mm joints at every 10 m<sup>2</sup>.
- For internal applications, create 3 mm joints at every 25 m<sup>2</sup>.
- In long, narrow applications, create 3 mm joints after every 8 meters.

Always respect all structural, fractionizing, and perimeter joints present on the surfaces.

### Cleaning



- Clean any excess adhesive from the tile surfaces and grout lines immediately with a damp sponge or cloth.

### Grouting

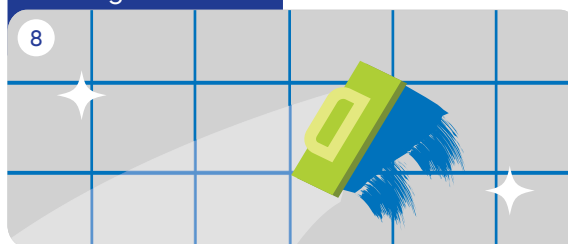

- Grouting should be carried out after 24 hours of tiling. It is advisable to use the appropriate grouting material from Magicrete range of cementitious or epoxy grouts.

## COVERAGE

- A coverage of 55-60 Sq. Ft. per bag of 20 Kg is received when used with a bed thickness of 3mm (using 6mm x 6mm square notched trowel).

Note: Coverage is based on smoothness and evenness of the substrate, and the thickness of mortar used.





## SHELF LIFE

Factory packed bags of Tile Laying Adhesive Standard + carries a shelf life of 12 months, if stored in cool & dry place. However, as temperature, humidity, water addition & other parameters vary from site to site.

## LIMITATIONS

Adhesives and grouts for tiles are not replacements for waterproof membranes. When a waterproof membrane is required, use Magicrete waterproofing products by Magicrete or any other waterproofing product available in the market.

## SAFETY PRECAUTIONS

- Keep out of reach of children.
- Wear suitable protective clothing, gloves, and eye/face protection.
- After contact with the skin, wash immediately with plenty of clean water.
- In case of eye contact, rinse immediately with plenty of clean water and seek medical advice.

## IMPORTANT NOTES

- Always add powder to water.
- Do not add excess water than recommended.
- Do not add extra cement or sand to tile adhesive, as it can disturb the Magicrete product's intended formulation and compromise its performance.
- Do not use on wet screed, surface must be fully cured (28 days).
- Do not use the adhesive to correct surface irregularities >12 mm. May go up to 15 mm in limited extent.
- Applicator must evaluate the use of an additional mechanical fastening system for extra security in case of heavy stone/large tiles for more than 3m height (such as steel hooks fastened to the substrate).
- Protect from direct rainfall/ foot traffic for at least 24 hours.
- Leave gap between the tiles with the help of spacers & fill gaps with Magicrete tile grout.
- It is mandatory to use appropriate size notched trowel to achieve required thickness of adhesive
- It is advisable to use Magicrete Ultrabond on the back surface of tile/stone when either substrate or tile/stoned to be applied is highly absorbent.
- Do not use on deformable substrate or substrates which are subject to vibration.

# magicrete®

magic behind happy homes



## Magicrete Building Solutions Pvt. Ltd.

(ISO 9001 :2015, ISO 14001 :2015 & ISO 45001 :2018 Certified co.)



101 Ritz Square, Near Narmad Library,  
Ghod Dod Road, Surat-395007 (Gujarat)

☎ 80 70 40 80 10

📧 [info@magicrete.in](mailto:info@magicrete.in)

🌐 [magicrete.in](http://magicrete.in)



SCAN FOR  
DIGITAL COPY

